

FORM NO. 1.

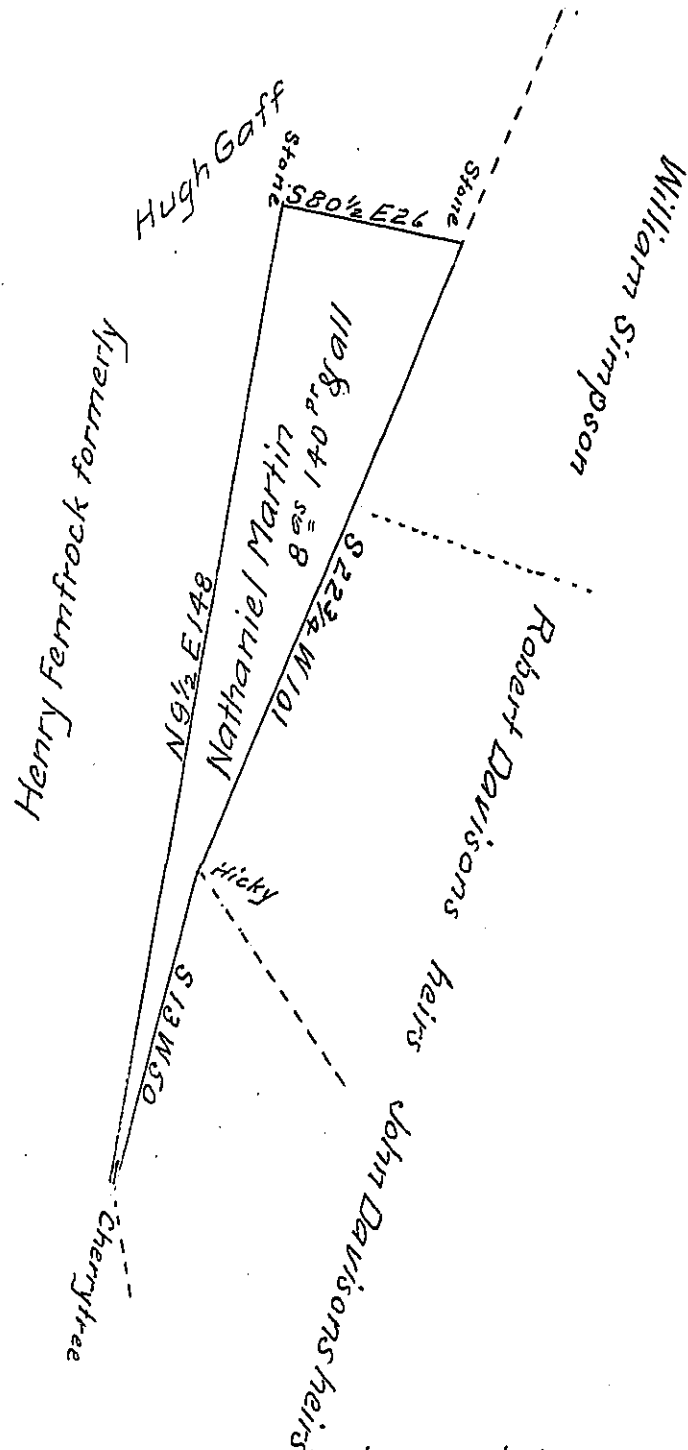

A Draught of a Peice of Land Situate in Antrim Township Franklin County Containing Eight acres and one hundred and forty perches and the usual Allowance of Six per Cent for roads &c. Surveyed April 7th 1813 in pursuance of a Warrant granted Nathaniel Martin Dated January 6th 1813

To Andrew Porter Esq^r Thomas Poe D.S.
Surveyor General of Penn^a

I do certify that the greater part of the land contained in the above Survey appears to be clear twenty or twenty five years, and a log house and kitchen thereon which appears to ^{be} erected a few months since, and a family residing therein, Also part of a log barn which appears to have been erected fifteen or twenty years, Given from under my hand this 7th day of April 1813
Thomas Poe D.S.

IN TESTIMONY that the above is a copy of the original remaining on file in the Department of Internal Affairs of Pennsylvania, made conformably to an Act of Assembly approved the 16th day of February 1833, I have hereunto set my hand and caused the Seal of said Department to be affixed at Harrisburg, this thirteenth day of January 1908.

Henry Houck
Secretary of Internal Affairs.